

| REV. | ECO/DDC | DESCRIPTION | DATE | DRAFT | CHECK | APV'D |
|------|---------|-------------|----------|--------|--------|-------|
| A | ---- | RELEASED. | 02-12-21 | V.J.C. | T.D.N. | |

| DIMENSIONS IN INCHES [MM] | | |
|---------------------------|----------------|----------------|
| HEIGHT-NOMINAL | HEIGHT-MINIMUM | HEIGHT-MAXIMUM |
| 26.0 [660.4] | 24.0 [609.6] | 28.0 [711.2] |
| 30.0 [762.0] | 28.0 [711.2] | 32.0 [812.8] |
| 34.0 [863.6] | 32.0 [812.8] | 36.0 [914.4] |
| 38.0 [965.2] | 36.0 [914.4] | 40.0 [1016.0] |
| 42.0 [1066.8] | 40.0 [1016.0] | 44.0 [1117.6] |

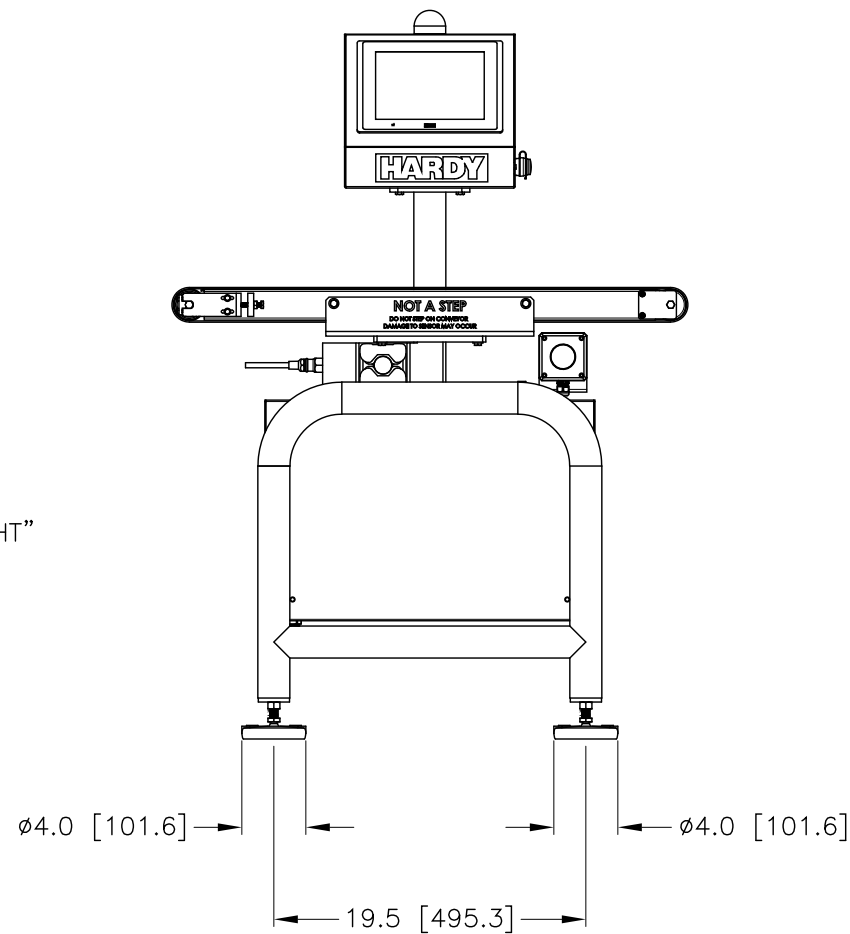
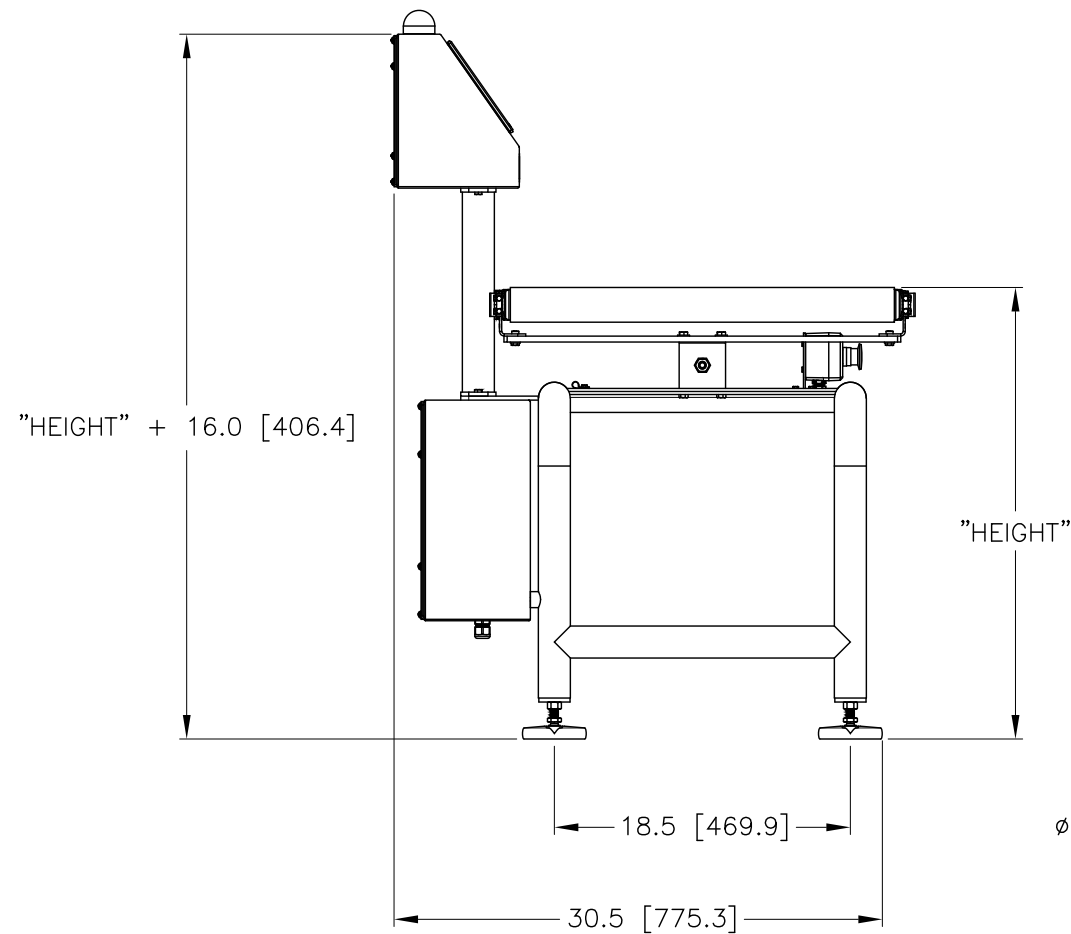
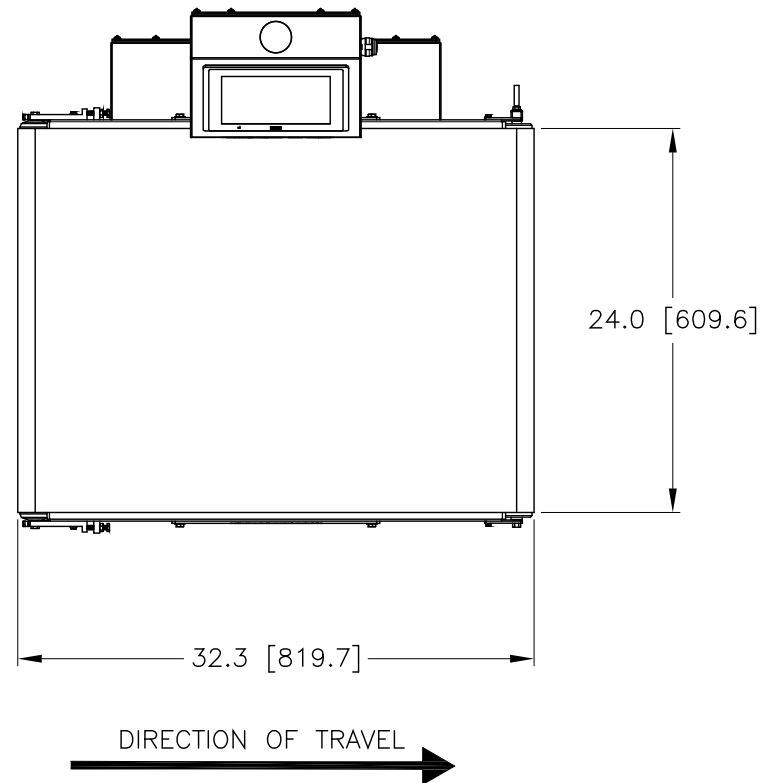

Customer Provided Variables

Package Information

| Description: | | | | |
|--------------|-------------|------------|--------------|------------|
| | Length (in) | Width (in) | Weight (lb.) | Rate (ppm) |
| Largest Pkg | | | | |
| Smallest Pkg | | | | |

Material Handling

| | Infeed Speed (fpm) | Controlled Spacing (Y/N) | Minimum Package Pitch (in) | Package Direction (L-R, R-L) |
|--------------|--------------------|--------------------------|----------------------------|------------------------------|
| Largest Pkg | | | | |
| Smallest Pkg | | | | |

Pitch to be stated as center to center spacing of one package to the next

Belt Type (check one): Black(PVC) White(FDA)

Roller (check one): Galv (IP54) SS (IP66)

Construction (check one): Painted Stainless

Performance

| Maximum Rcmd. Weight | Maximum Speed | Enviro. Rating | Voltage / Current | Air (Reject Only) |
|----------------------|---------------|----------------|-------------------|-------------------|
| 40 lbs | 120FPM | | 120 VAC / 5 AMP | 80 PSI / 4 CFM |

Customer Approval Signature _____
 Print Name _____
 Date _____

NOTES: UNLESS OTHERWISE SPECIFIED

PROPRIETARY NOTICE
 ALL DATA AND INFORMATION CONTAINED IN OR DISCLOSED BY THIS DOCUMENT IS CONFIDENTIAL AND PROPRIETARY INFORMATION OF HARDY PROCESS SOLUTIONS INC. AND ALL RIGHTS THEREIN ARE EXPRESSLY RESERVED. BY ACCEPTING THIS MATERIAL THE RECIPIENT AGREES THAT THIS MATERIAL AND THE INFORMATION CONTAINED THEREIN IS HELD IN CONFIDENCE AND IN TRUST AND SHALL NOT BE USED, COPIED, REPRODUCED IN WHOLE OR IN PART, NOR ITS CONTENTS REVEALED IN ANY MANNER TO OTHERS, EXCEPT TO MEET THE SPECIFIC PURPOSE FOR WHICH IT WAS DELIVERED.

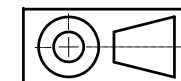

| 0588-0193 | | LAYOUT DRAWING, HPS-CW2, 24"x32", LEFT TO RIGHT DIRECTION | | |
|---------------------------------------------------------------------|-----|-----------------------------------------------------------|-------------|---------------------------------------------------------------------------------------------------|
| ITEM | QTY | PART NUMBER | DESCRIPTION | COMMENTS |
| PARTS LIST | | | | |
| UNLESS OTHERWISE SPECIFIED DIMENSIONS ARE IN INCHES TOLERANCES ARE: | | CONTRACT NO. | | |
| FRACTIONS: N/A | | APPROVALS | | |
| DECIMALS: .XX = ±.03 | | DRAWN | DATE | TITLE HARDY PROCESS SOLUTIONS LAYOUT DRAWING, HPS-CW2, 24"x32", LEFT TO RIGHT DIR |
| .XXX = ±.010 | | V. CHULA | 01-26-21 | |
| ANGLES: ±0°, 30° | | CHECKED | DATE | |
| | | T. NORMAN | 02-12-21 | |
| MATERIAL | | APPROVED | DATE | SIZE |
| | | V. CHULA | 02-12-21 | FSCM |
| FINISH | | ISSUED | DATE | DRAWING NO. |
| | | V. CHULA | 02-12-21 | 0588-0193 |
| | | PRODUCTION | DATE | REV. |
| | | | 02-12-21 | A |
| DO NOT SCALE DRAWING | | FILE NAME: 0588-0193A1.DWG | | SCALE: NONE |
| | | | | SHEET 1 OF 1 |