

REV.	ECO/DDC	DESCRIPTION	DATE	DRAFT	CHECK	APV'D
A	----	RELEASED.	07-28-08	V.J.C.	S.N.	V.J.C.
B	10677	REVISED PER ECN.	09-23-09	V.J.C.	C.B.	V.J.C.
C	11553	REVISED PER ECN; CABLE LENGTH WAS 0.5 METERS.	11-03-14	V.J.C.	N.H.S.	V.J.C.

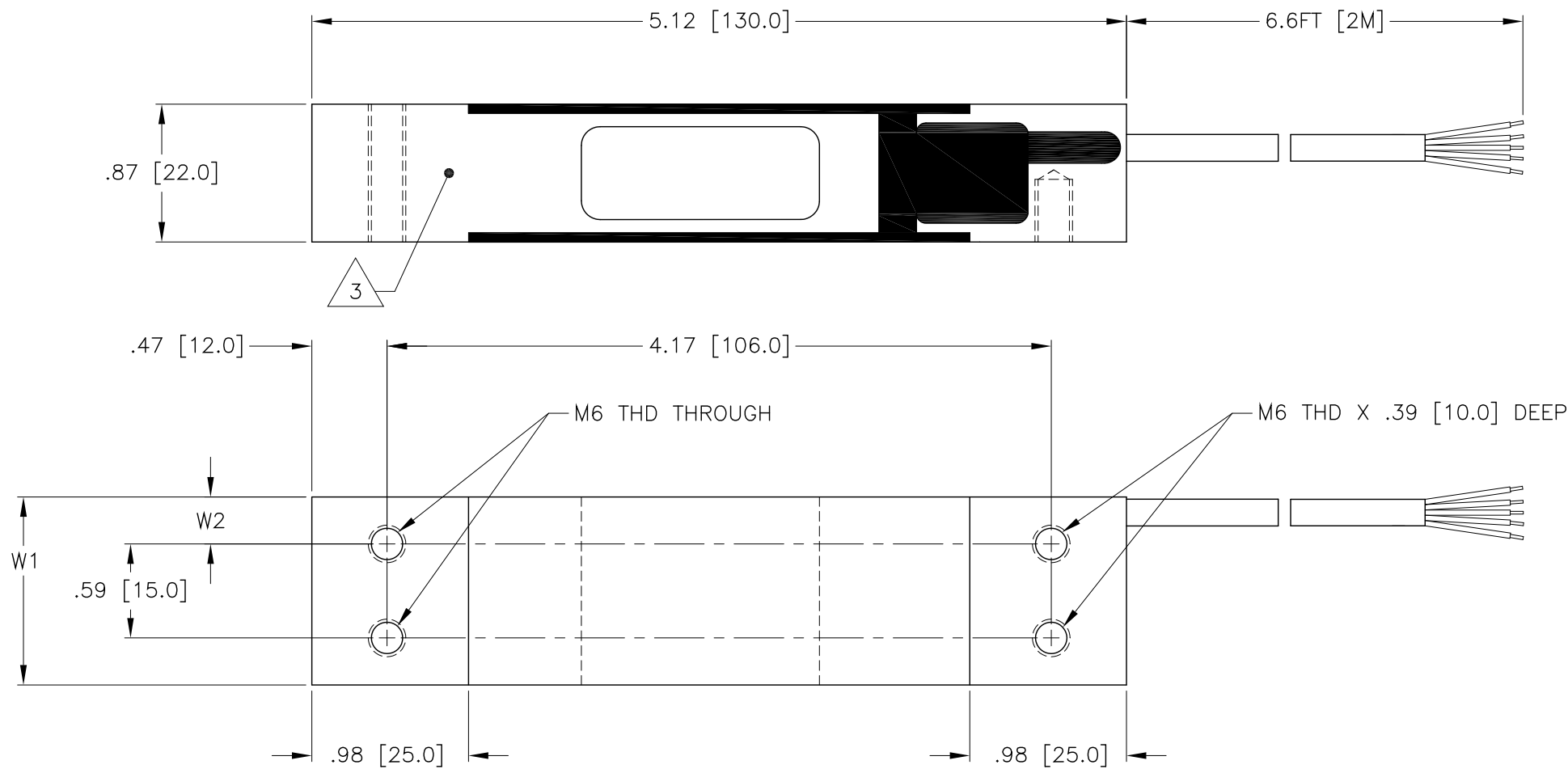

8. LOAD SENSOR OPERATING TEMPERATURE RATING IS -20°C TO $+65^{\circ}\text{C}$. USAGE OF LOAD SENSOR AT TEMPERATURES BELOW -20°C REQUIRES THAT THE LOAD SENSOR AND CABLE BE TEMPERATURE CONTROLLED.
7. THIS DRAWING IS SUBJECT TO CHANGE WITHOUT NOTICE.
6. CABLE IS 24 AWG, 4 CONDUCTOR, SHIELDED, 6.6FT [2 METERS] LONG. CABLE SHIELD IS FLOATING.
5. WIRE COLOR CODE:

EXCITATION +	GREEN
EXCITATION -	BLACK
SIGNAL +	WHITE
SIGNAL -	RED
SHIELD	YELLOW
C2 +	GRAY
C2 -	VIOLET

INSTALLED AT CABLE END

4. CABLE WIRE ENDS ARE STRIPPED BACK 0.5 INCHES [12.7MM] AND TINNED. CABLE JACKET IS STRIPPED BACK APPROXIMATELY 5 INCHES [127MM].

 LOCATION OF SERIAL NUMBER LABEL.

2. MATERIAL: SENSOR - ALUMINIUM

1. RATED OUTPUT: $2\text{mV/V} \pm 5\%$

NOTES: UNLESS OTHERWISE SPECIFIED

PROPRIETARY NOTICE
ALL DATA AND INFORMATION CONTAINED IN OR DISCLOSED BY THIS DOCUMENT IS CONFIDENTIAL AND PROPRIETARY INFORMATION OF HARDY PROCESS SOLUTIONS INC. AND ALL RIGHTS THEREIN ARE EXPRESSLY RESERVED. BY ACCEPTING THIS MATERIAL THE RECIPIENT AGREES THAT THIS MATERIAL AND THE INFORMATION CONTAINED THEREIN IS HELD IN CONFIDENCE AND IN TRUST AND SHALL NOT BE USED, COPIED, REPRODUCED IN WHOLE OR IN PART, NOR ITS CONTENTS REVEALED IN ANY MANNER TO OTHERS, EXCEPT TO MEET THE SPECIFIC PURPOSE FOR WHICH IT WAS DELIVERED.

CAPACITY LBS [KG]	MODEL NUMBER	W1	W2
11 [5]	HI SPA22-5	1.00 [25.4]	.20 [5.2]
22 [10]	HI SPA22-10	1.18 [30.0]	.30 [7.5]
44 [20]	HI SPA22-20		
66 [30]	HI SPA22-30		
88 [40]	HI SPA22-40		
110 [50]	HI SPA22-50		

ITEM	QTY	0588-0136	OUTLINE DRAWING, LOAD SENSOR, HI SPA22 SERIES	COMMENTS
PARTS LIST				
UNLESS OTHERWISE SPECIFIED DIMENSIONS ARE IN INCHES [MM] TOLERANCES ARE: DECIMALS: .XX = ± 0.01 [.25] .XXX = N/A ANGLES: $\pm 0^{\circ}, 30'$		CONTRACT NO.		HARDY PROCESS SOLUTIONS
MATERIAL		APPROVALS		
FINISH		DRAWN V. CHULA	DATE 07-25-08	
DO NOT SCALE DRAWING		CHECKED S. NAVARRO	DATE 07-25-08	
		APPROVED V. CHULA	DATE 07-28-08	
		ISSUED V. CHULA	DATE 07-28-08	
		PRODUCTION	DATE	
SIZE	FSCM	DRAWING NO.		REV.
D	21316	0588-0136		C
FILE NAME: 588136C1.DWG		SCALE: NONE		SHEET 1 OF 1