

DIMENSIONS— INCHES & [mm]

REV.	ECO/DDC	DESCRIPTION	DATE	DRAFT	CHECK	APV'D
A	----	RELEASED.	11-11-20	V.J.C.	J.I.	T.D.N.

MODEL NUMBER	CAPACITY KG	MOUNT THD	CABLE LENGTH FT [M]
HI SPAL03-0.3KG	0.3KG	M3 X 0.5 9.0MM DEEP	1.6FT [0.5M]
HI SPAL03-0.5KG	0.5KG		
HI SPAL03-1KG	1KG		
HI SPAL03-2KG	2KG		
HI SPAL03-3KG	3KG		
HI SPAL03-5KG	5KG		

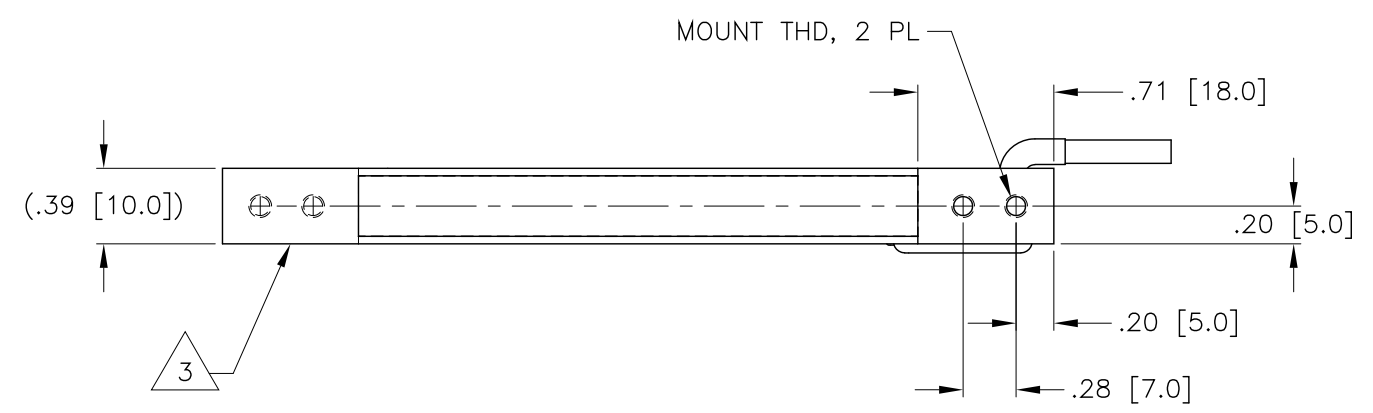
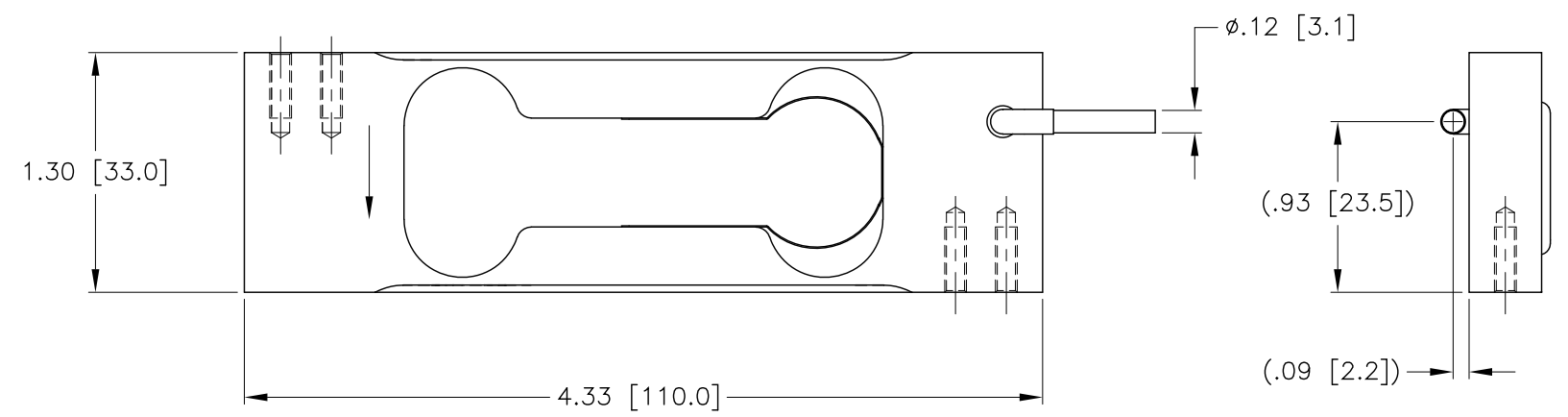
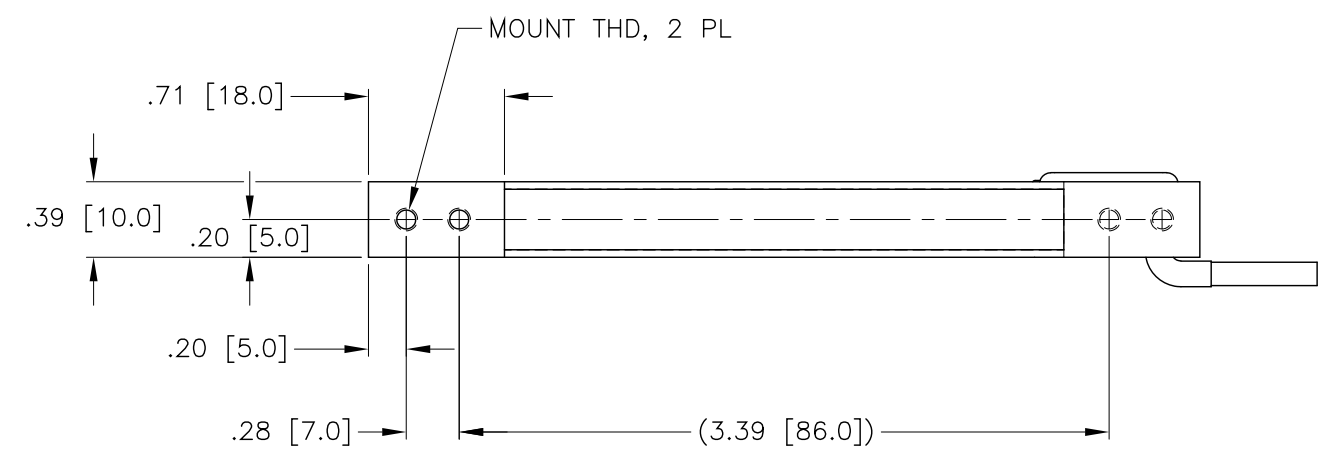

9. SEE SHEET 2 FOR FULL SCALE 2 DIMENSIONAL DROP-IN CAD FILE VIEWS.
 8. LOAD CELL SAFE OPERATING TEMPERATURE RATING IS -20°C TO +65°C. USAGE OF LOAD CELL AT TEMPERATURES BELOW -20°C REQUIRES THAT THE LOAD CELL AND CABLE BE TEMPERATURE CONTROLLED.
 7. LOAD CELL IS ALUMINUM.
 6. CABLE IS UNSHIELDED, 4 CONDUCTOR, 28AWG. SEE TABLE FOR CABLE LENGTHS.
 5. LOAD CELL COLOR CODE:
 EXCITATION + GREEN
 EXCITATION - BLACK
 SIGNAL + WHITE
 SIGNAL - RED
 4. CABLE WIRE ENDS ARE STRIPPED BACK AND TINNED.
- △ LOCATION OF MODEL/SERIAL NUMBER LABEL.
2. THIS DRAWING IS SUBJECT TO CHANGE WITHOUT NOTICE.
 1. RATED OUTPUT: 1.0mV/V ±0.1mV/V%.

NOTES: UNLESS OTHERWISE SPECIFIED

PROPRIETARY NOTICE
 ALL DATA AND INFORMATION CONTAINED IN OR DISCLOSED BY THIS DOCUMENT IS CONFIDENTIAL AND PROPRIETARY INFORMATION OF HARDY PROCESS SOLUTIONS INC. AND ALL RIGHTS THEREIN ARE EXPRESSLY RESERVED. BY ACCEPTING THIS MATERIAL THE RECIPIENT AGREES THAT THIS MATERIAL AND THE INFORMATION CONTAINED THEREIN IS HELD IN CONFIDENCE AND IN TRUST AND SHALL NOT BE USED, COPIED, REPRODUCED IN WHOLE OR IN PART, NOR ITS CONTENTS REVEALED IN ANY MANNER TO OTHERS, EXCEPT TO MEET THE SPECIFIC PURPOSE FOR WHICH IT WAS DELIVERED.

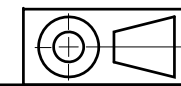

ITEM	QTY	PART NUMBER	DESCRIPTION	COMMENTS
0588-0188 OUTLINE DRAWING, LOAD CELL, HI SPAL03 SERIES				
PARTS LIST				
UNLESS OTHERWISE SPECIFIED DIMENSIONS ARE IN INCHES [MM]		CONTRACT NO.		
TOLERANCES ARE: DECIMALS: .XX = ±0.01 [.25] .XXX = N/A ANGLES: ±0°, 30°		APPROVALS		
MATERIAL		DRAWN V. CHULA	DATE 10-28-20	TITLE HARDY PROCESS SOLUTIONS OUTLINE DRAWING, LOAD CELL, HI SPAL03 SERIES
FINISH		CHECKED J. IBARRA	DATE 10-28-20	
DO NOT SCALE DRAWING		APPROVED T. NORMAN	DATE 11-11-20	
		ISSUED V. CHULA	DATE 11-11-20	
SIZE	FSCM	DRAWING NO.	REV.	
D	21316	0588-0188	A	
FILE NAME: 588188A1.DWG		SCALE: NONE	SHEET 1 OF 2	

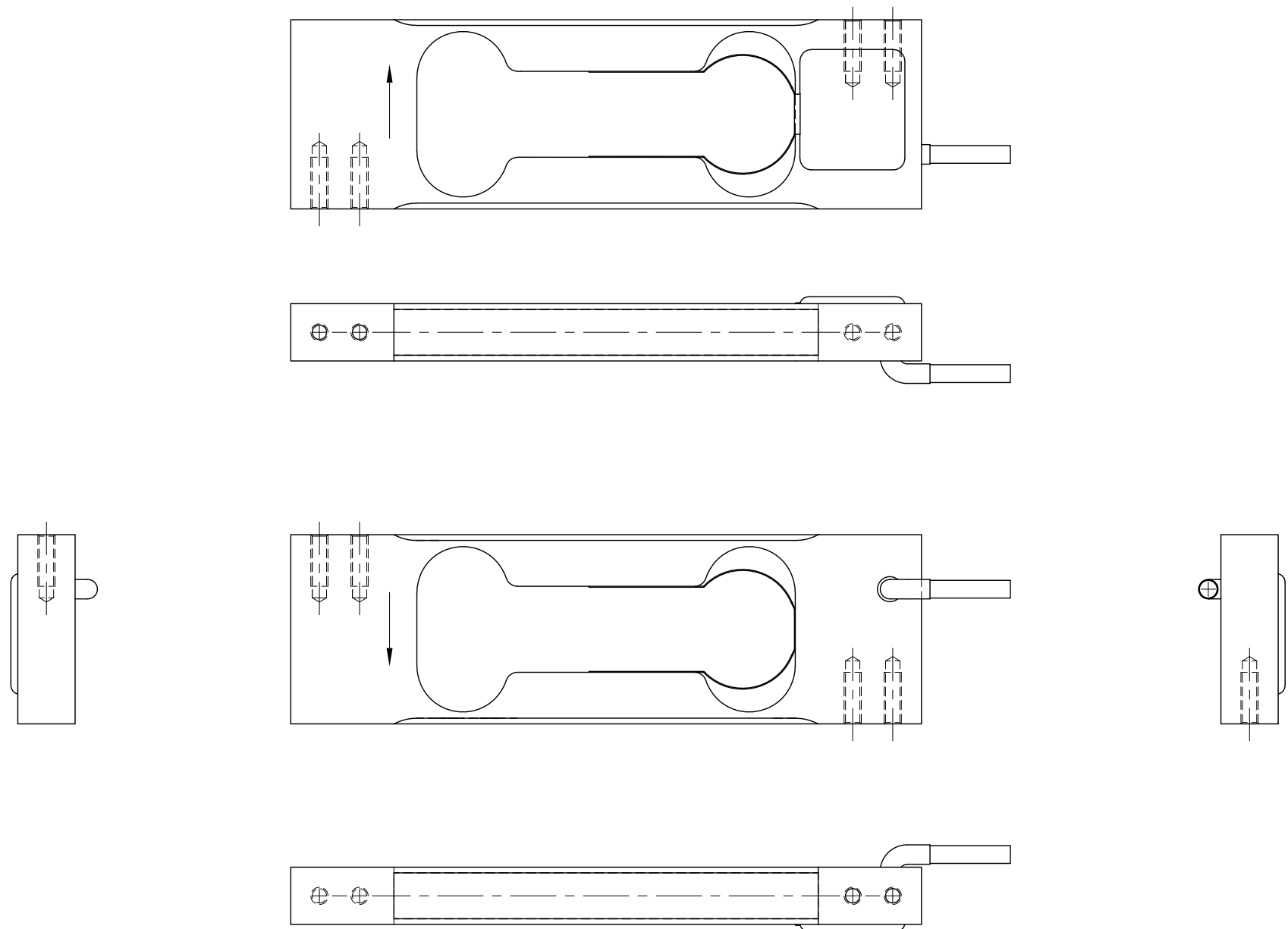

DROP-IN CAD FILE VIEWS

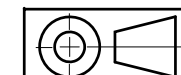

HARDY PROCESS SOLUTIONS			
TITLE OUTLINE DRAWING, LOAD CELL, HI SPAL03 SERIES			
SIZE	FSCM	DRAWING NO.	REV.
D	21316	0588-0188	A
FILE NAME: 588188A1.DWG		SCALE: NONE	SHEET 2 OF 2